

Interior Finish + Fixture Schedule

Electrical + Lighting Schedule

For : Patient Care Analytics

Version 15D

as of: October 20, 2020

Updated November 1, 2020 / Updated Nov 11, 2020/ Updated Nov 14, 2020

Updated November 19, 2020 , Updated November 21, 2020, Updated November 24, 2020

Client / Project Address: 72030 Metroplex Drive
Thousand Palms CA 92276
Contact : Leigh Bohnet, CFO
Voice: (760) 343-7031
Email: lbohnet@pcahealthcare.com

Interior Designer/Specifier: Design Collective Group Inc
73350 El Paseo, Showroom #103
Palm Desert, CA 92260
Contact : Michael A. Thomas, FASID, CAPS
Voice: 760-322-3784
Email: mat@designcollectivegroup.com

• General Project Notes:

Retain all existing wood-grain passage/ entry doors and hardware

Remove all existing carpeting and carpeted base; floor prep and installation of loose-lay vinyl tiles including vinyl base + adhesives; LVT provided by ID
<https://www.karndean.com/en/floors/easy-fit-ranges/karndean-looselay>

Systems free-standing furniture + fixtures provided and installed by others

New power and CAT 5/6 cable installation to be coordinated with Systems Furniture vendor's provided plans + specifications

All existing floor outlets to remain in place; floor covers / access panels to be replaced with new brushed steel covers.

Replace all HVAC vents / Finish: White

Remove all non-structural power poles + leave electrical above ceiling line; power to be used, if practical, for power + Cat 5/6 for power poles of Systems FFE.

Remove all systems panels, dividers and properly dispose per Client instructions Retain (7) 2- and (86) 3-drawer file pedestals; temporary storage location to be determined by Client

Refer to ID drawing Version 15b for current details on layout and plan

For additional info on this project, go to: <https://www.thedesigncollectivegroup.com/pca-interior-finishes.html>

INTERIOR

• Main Entrance

Finishes

Prep walls, repair as needed, prime and paint

- Dunn Edwards DE5542 Early Harvest / Eggshell Finish

Prep sheetrock ceiling, repair as needed, prime and paint

- Dunn Edwards DEW 380 White / Flat Finish

Prep millwork, repair as needed, prime and paint

- Dunn Edwards DET619 Celluloid / Low Sheen Finish

Existing tile and base remains as installed

Existing stain glass panels remain as installed

Replace HVAC grills with new in white.

Electrical + Lighting

Retain existing light fixture; re-lamp with LED T8 Tube, 18watts, Frosted Lens, 2400 Lumens, 3500K-Neutral White, 240 min. beam spread; note: fixture may require new frosted lens

• Lobby

Finishes

Prep millwork, repair as needed, prime and paint

Dunn Edwards, DET619 Celluloid / Low Sheen Finish
Strip all walls, prep, prime and install new 54" wide, 20oz Type II vinyl wallcoverings - materials provided by ID (interior designer)

- Meridian #2VMN-02 / Light In August (overall woven texture - no repeat)
Non-reverse hang; random match; osnaburg backing; Class A ASTM E 84
- South Wall Only: Atmosphere #A-180-597 / Metallica (horizontal pattern)
Reverse hang; random match; osnaburg backing; Class A ASTM E 84

Retain existing counter, floor tiles, millwork, shutter panels

Replace existing suspended ceiling tiles + t-grid with new

- Armstrong #1490 / Yuma White, 2' x 2' with Tegular Edge
Use: Prelude XL 15/16-in suspension system @ 108" AFF

Electrical + Lighting

Retain existing troffer light fixtures; re-lamp with LED T8 Tube, 18watts, Frosted Lens, 2400 Lumens, 3500K-Neutral White, minimum 240 beam spread

Add switched recessed wall outlet for future company illuminated sign, to be installed on south wall, centered R2L, 66" AFF - a final location to be verified with sign manufacturer; locate switch in suitable location, ganged with others if reasonable.

• Lobby Hall

Finishes

Prep existing millwork, repair as needed, prime and paint

- Dunn Edwards DET619 Celluloid / Low Sheen Finish

Prep, prime and install new 54" wide, 20oz Type II vinyl wallcoverings; materials provided by ID

- Haggerston #8-3365 / Dandelion (multi-tone neutral)
Reverse hang; random match; osnaburg backing; Class A ASTM E 84

Replace existing suspended ceiling tiles + t-grid with new

- Armstrong #1490 / Yuma White, 2' x 2' with Tegular Edge
Use: Prelude 15/16-in suspension system @ 108" AFF

Electrical + Lighting

Replace light fixture with 2' x 4' LED Back-Lit Flat Panel, 20 watt, 2400 Lumens, 3500K-Neutral White

- **Two Guest Single-Stall Bathrooms**

Remove toilet, sink, faucet, mirror, wall-mounted hand dryers and demo wall tiles down to floor line

Skin walls with new drywall, tape, float, prime and prep for wallcovering
Finishes

Prep millwork, repair as needed, prime and paint

- Dunn Edwards DET619 Celluloid / Low Sheen Finish

Install wallcoverings; materials provided by ID

- Meridian #2VMN-02 / Light In August (overall woven texture - no repeat)

 - Non-reverse hang; random match; osnaburg backing; Class A ASTM E 84

- West Wall Only: Atmosphere #A-180-597 / Metallica (horizontal pattern)

 - Reverse hang; random match; osnaburg backing; Class A ASTM E 84

Install new porcelain floor tile / Set square

- Tile: Marazzi Vesale Stone 13" x 13" UF2P Color: Smoke

- Glazed porcelain stoneware

https://digitalassets.daltile.com/content/dam/Marazzi/website/documents/product-detail-page/vesale-stone/MZ_VesaleStone_Brochure.pdf

- Tile Base: Marazzi / Vesale Stone UF27 / Color: Smoke (2" x 2")

 - Glazed porcelain stoneware; 13" x 13" sheet format

Finished Height to be 8" / Finish top of tiles with Schluter Systems: A100

Color: Brushed Chrome

https://digitalassets.daltile.com/content/dam/Marazzi/website/documents/product-detail-page/vesale-stone/MZ_VesaleStone_Brochure.pdf

- Grout color: Custom Building Products #542 Graystone

Replace existing suspended ceiling tiles + t-grid with new

- Armstrong @#1490 / Yuma White, 2' x 2' with Tegular Edge

 - Prelude 15/16-in suspension system @ 108" AFF

<https://www.armstrongceilings.com/commercial/en-us/commercial-ceilings-walls/canyon-ceiling-tiles/item/1490.html>

Plumbing

Install new ADA floor mounted toilet w/ antimicrobial flushometer bowl

- Kohler K-96057-SS-0 Highcliff Ultra / Color White

<https://www.us.kohler.com/us/highcliff-ultra-floor-mounted-top-spud-antimicrobial-flushometer-bowl/productDetail/commercial-toilets/1330605.htm?skuId=1330599&brandId=431955>

Install touchless flushometer

- Kohler K-7521-CP / Chrome Polish

<https://www.us.kohler.com/us/wave-touchless-hybrid-1.28-gpf-toilet-flushometer/productDetail/flushometers/841542.htm?brandId=431955&skuId=841515>

Install new wall hung sink

- Kohler K-2084-R-0 Wall hung sink basin with single faucet hole + right-hand soap dispenser hole Color: White

<https://www.us.kohler.com/us/soho-20-x-18-wall-mount-concealed-arm-carrier-bathroom-sink-right-hand-soap-dispenser-hole/productDetail/sinks/417366.htm?skuId=362048&brandId=432252>

Install new sink faucet + soap dispenser

-Toto # TEL101-D10ET#CP Ecopower Faucet Finish Chrome

<https://www.totousa.com/standard-ecopowerfaucet-10-gpm>

-Toto #TES100AA#CP / Sensor Operated Soap Dispenser - AC

<https://www.totousa.com/toto-sensor-operated-soap-dispenser-ac>

Install new tilt mirror above sink

-Bobrick B-294-1830 / Angle frames two-position tilt style mirror with frame

<https://www.bobrick.com/products/washroom-accessories/restroom-accessories-catalog/mirrors/product/b-294-1830/>

Install new in-wall paper towel dispenser with waste receptacle

-Bobrick #3974 Recessed Automatic Roll Towel Dispenser

<https://www.bobrick.com/products/washroom-accessories/restroom-accessories-catalog/combination-towel-waste-units/product/b-3974/>

Install new recessed toilet paper dispenser

-Bobrick B-35883 Trimline Series double-roll toilet paper dispenser

<https://www.bobrick.com/products/washroom-accessories/washroom-accessories-catalog/product/b-35883/>

Install new grab bars / Back wall @36" long / Side Wall @ 42"

- Bobrick B-5806 - 36" / 42" stainless steel grab bar with snap flange

Finish: satin stainless steel

<https://www.bobrick.com/products/washroom-accessories/toilet-compartment-accessories/toilet-compartment-catalog/grab-bars/product/b-5806-series/?https://www.bobrick.com/products/washroom-accessories/toilet-compartment-accessories/toilet-compartment-catalog/grab-bars/product/b-5806-series/>

Note: Inspect water lines, shut-offs; update as needed

Lighting + Electrical

Replace light fixture with 2' x 4' LED Back-Lit Flat Panel, 20 watt, 2400 Lumens, 3500K-Neutral White

Upgrade light switches to occupancy / vacancy sensor-type

Note: Touchless feature on soap dispenser requires AC power

• Main Hall, West Hall, North Hall

Finishes

Prep walls, millwork, repair as needed, prime and paint

- Dunn Edwards DET619 Celluloid / Low Sheen Finish

Install wallcovering; materials provided by ID

- GOH #31946653 Savannah / Cotton

Reverse hang; random match; osnaburg backing; Class A ASTM E 84

Metal doors to HVAC and Electrical to be sanded, primed and painted

- Dunn Edwards DET619 Celluloid / Low Sheen Finish

Replace existing suspended ceiling tiles + t-grid with new

- Armstrong #1490 / Yuma White, 2' x 2' with Tegular Edge

Prelude 15/16-in suspension system @ 108" AFF

<https://www.armstrongceilings.com/commercial/en-us/commercial-ceilings-walls/canyon-ceiling-tiles/item/1490.html>

Lighting + Electrical

Replace light fixtures with 2' x 4' LED Back-Lit Flat Panel, 20 watt, 2400 Lumens, 3500K-Neutral White

• Two Main Employee Bathrooms

Finishes

Prep millwork, repair as needed, prime and paint

- Dunn Edwards DET619 Celluloid / Low Sheen Finish

Install wallcoverings; materials provided by ID

- Men's: Sherlock / Goldens Straw T2-SH-02 / 54" 20oz vinyl

Reverse hang; random match; osnaburg backing; Class A ASTM E 84

- Women's: Atmosphere A180-127 Fossil / 54" 20oz vinyl

Reverse hang; random match; osnaburg backing; Class A ASTM E 84

Replace bathroom partitions with new

- ASI Global Partitions Moisture Guard Plastic Laminate / Floor Anchored + Overhead Braced; hardware in brushed steel

Panel Finish: Western Suede #4110 (neutral speckle pattern)

https://globalpartitions.com/wp-content/uploads/GLOBAL-PLAM-SPECS_4in1.pdf

Install new grab bars in north partition/ Back wall @ 36" long / Side Wall @ 42"

- Bobrick B-5806 - 36" / 42" stainless steel grab bar with snap flange - or equal
Finish: satin stainless steel

<https://www.bobrick.com/products/washroom-accessories/toilet-compartment-accessories/toilet-compartment-catalog/grab-bars/product/b-5806-series/?https://www.bobrick.com/products/washroom-accessories/toilet-compartment-accessories/toilet-compartment-catalog/grab-bars/product/b-5806-series/>

Install new sink faucet

- Toto # TEL101-D10ET#CP Ecopower Faucet Finish Chrome

Note: Inspect water lines, shut-offs; update as needed

Remove existing wood cap at top of wall tiles and replace with tile cap

- Bedrosians / SKU: TRVSILMSTVCAP / Silver Mist 2" by 12"

<https://www.bedrosians.com/en/product/detail/silver-mist-trim/?itemNo=TRVSILMSTVCAP>

Grout color: Match existing grout color in wall tiles

Install new in-wall paper towel dispenser with waste receptacle right facing wall of sinks

- Bobrick #3974 Recessed Automatic Roll Towel Dispenser

<https://www.bobrick.com/products/washroom-accessories/restroom-accessories-catalog/combo-towel-waste-units/product/b-3974/>

Replace existing suspended ceiling tiles + t-grid with new

- Armstrong #1490 / Yuma White, 2' x 2' with Tegular Edge
Prelude 15/16-in suspension system @ 108" AFF

Lighting + Electrical

Replace light fixtures with 2' x 4' LED Back-Lit Flat Panel, 20 watt, 2400 Lumens, 3500K-Neutral White

Upgrade light switches to occupancy / vacancy sensor-type

• **Future Workgroup Office**

Finishes

Prep millwork, repair as needed, prime and paint

- Dunn Edwards DET619 Celluloid / Low Sheen Finish

Install wallcoverings; materials provided by ID

- WG-In A Flash / Posh Pebble GOH 31946622 / 54" 20oz vinyl
Reverse hang; random match; osnaburg backing; Class A ASTM E 84
- East Wall Only: H20 / Rain R2-HO-10 / 54" 20oz vinyl
Repeat: 18" V, 52" H; osnaburg backing; Class A ASTM E 84

Replace existing suspended ceiling tiles + t-grid with new

- Armstrong #1490 / Yuma White, 2' x 4' with Tegular Edge
Prelude 15/16-in suspension system @ 108" AFF

<https://www.armstrongceilings.com/commercial/en-us/commercial-ceilings-walls/canyon-ceiling-tiles/item/1490.html>

Electrical + Lighting

Retain existing troffer light fixtures; re-lamp with LED T8 Tube, 18watts, Frosted Lens, 2400 Lumens, 3500K-Neutral White, minimum 240 beam spread

• **Flex Office A**

Finishes

Prep millwork, repair as needed, prime and paint

- Dunn Edwards DET619 Celluloid / Low Sheen Finish

Install wallcoverings; materials provided by ID

- WG-In A Flash / Posh Pebble GOH 31946622 / 54" 20oz vinyl
Reverse hang; random match; osnaburg backing; Class A ASTM E 84
- West Wall Only: H20 / Rain R2-HO-10 / 54" 20oz vinyl
Repeat: 18" V, 52" H; osnaburg backing; Class A ASTM E 84

Replace existing suspended ceiling tiles + t-grid with new

- Armstrong #1490 / Yuma White, 2' x 4' with Tegular Edge
Prelude 15/16-in suspension system @ 108" AFF

<https://www.armstrongceilings.com/commercial/en-us/commercial-ceilings-walls/canyon-ceiling-tiles/item/1490.html>

Electrical + Lighting

Retain existing troffer light fixtures; re-lamp with LED T8 Tube, 18watts, Frosted Lens, 2400 Lumens, 3500K-Neutral White, minimum 240 beam spread

• **Compliance Department**

Finishes

Prep millwork, repair as needed, prime and paint

- Dunn Edwards DET619 Celluloid / Low Sheen Finish

Install wallcoverings; materials provided by ID

- WG-In A Flash / Posh Pebble GOH 31946622 / 54" 20oz vinyl
Reverse hang; random match; osnaburg backing; Class A ASTM E 84
- East Wall Only: H20 / Rain R2-HO-10 / 54" 20oz vinyl
Repeat: 18" V, 52" H; osnaburg backing; Class A ASTM E 84

Replace existing suspended ceiling tiles + t-grid with new

- Armstrong #1490 / Yuma White, 2' x 4' with Tegular Edge
Prelude 15/16-in suspension system @ 108" AFF

<https://www.armstrongceilings.com/commercial/en-us/commercial-ceilings-walls/canyon-ceiling-tiles/item/1490.html>

Electrical + Lighting

Retain existing troffer light fixtures; re-lamp with LED T8 Tube, 18watts, Frosted Lens, 2400 Lumens, 3500K-Neutral White, minimum 240 beam spread

Install GFCI wall outlet on north wall, approx 30" in from east exterior wall @ 42" AFF; mount horizontal for future coffee bar

• **HR Manager Office**

Finishes

Prep millwork, repair as needed, prime and paint

- Dunn Edwards DET619 Celluloid / Low Sheen Finish

Install wallcoverings; materials provided by ID

- WG-In A Flash / Posh Pebble GOH 31946622 / 54" 20oz vinyl
Reverse hang; random match; osnaburg backing; Class A ASTM E 84
- East Wall Only: H20 / Rain R2-HO-10 / 54" 20oz vinyl
Repeat: 18" V, 52" H; osnaburg backing; Class A ASTM E 84

Replace existing suspended ceiling tiles + t-grid with new

- Armstrong #1490 / Yuma White, 2' x 2' with Tegular Edge

Prelude 15/16-in suspension system @ 108" AFF

<https://www.armstrongceilings.com/pdbupimages-clg/219424.pdf/download/data-sheet-ledges.pdf>

Electrical + Lighting

Retain existing troffer light fixtures; re-lamp with LED T8 Tube, 18watts, Frosted Lens, 2400 Lumens, 3500K-Neutral White, minimum 240 beam spread

• **HR Department Office**

Finishes

Prep millwork, repair as needed, prime and paint

- Dunn Edwards DET619 Celluloid / Low Sheen Finish

Install wallcoverings; materials provided by ID

- WG-In A Flash / Posh Pebble GOH 31946622 / 54" 20oz vinyl

Reverse hang; random match; osnaburg backing; Class A ASTM E 84

- East Wall Only: H20 / Rain R2-HO-10 / 54" 20oz vinyl

Repeat: 18" V, 52" H; osnaburg backing; Class A ASTM E 84

Replace existing suspended ceiling tiles + t-grid with new

- Armstrong #8013 Ledges II / White, 2' x 2' with Flush Tegular Edge

Superfine 9/16" suspension system @ 108" AFF

<https://www.armstrongceilings.com/pdbupimages-clg/219424.pdf/download/data-sheet-ledges.pdf>

Electrical + Lighting

Retain existing troffer light fixtures; re-lamp with LED T8 Tube, 18watts, Frosted Lens, 2400 Lumens, 3500K-Neutral White, minimum 240 beam spread

• **New Flex Office B**

Finishes

Prep millwork, repair as needed, prime and paint

- Dunn Edwards DET619 Celluloid / Low Sheen Finish

Install wallcoverings; materials provided by ID

- WG-In A Flash / Posh Pebble GOH 31946622 / 54" 20oz vinyl

Reverse hang; random match; osnaburg backing; Class A ASTM E 84

- East Wall Only: H20 / Rain R2-HO-10 / 54" 20oz vinyl

Repeat: 18" V, 52" H; osnaburg backing; Class A ASTM E 84

Replace existing suspended ceiling tiles + t-grid with new

- Armstrong #1490 / Yuma White, 2' x 4' with Tegular Edge
Prelude 15/16-in suspension system @ 108" AFF

<https://www.armstrongceilings.com/commercial/en-us/commercial-ceilings-walls/canyon-ceiling-tiles/item/1490.html>

Electrical + Lighting

Retain existing troffer light fixtures; re-lamp with LED T8 Tube, 18watts, Frosted Lens, 2400 Lumens, 3500K-Neutral White, minimum 240 beam spread

• **East VP Office**

Finishes

Prep millwork, repair as needed, prime and paint

- Dunn Edwards DET619 Celluloid / Low Sheen Finish

Install wallcoverings; materials provided by ID

- WG-Sisal Song / Ebony & Ivory GOH 31946632
Reverse hang; random match; osnaburg backing; Class A ASTM E 84
 - East Wall Only WG-Denail DNL9020 Color: Storm
Reverse hang; random match; osnaburg backing; Class A ASTM E 84
- Note: This wallcovering to be installed horizontal

Replace existing suspended ceiling tiles + t-grid with new

- Armstrong #8013 Ledges II / White, 2' x 2' with Flush Tegular Edge
Superfine 9/16" suspension system @ 108" AFF

<https://www.armstrongceilings.com/pdbupimages-clg/219424.pdf/download/data-sheet-ledges.pdf>

Electrical + Lighting

Retain existing troffer light fixtures; re-lamp with LED T8 Tube, 18watts, Frosted Lens, 2400 Lumens, 3500K-Neutral White, minimum 240 beam spread

• **New Admin Office / Exterior Side Of West Wall of VP Office only**

Finishes

Prep millwork, repair as needed, prime and paint

- Dunn Edwards DET619 Celluloid / Low Sheen Finish

Install wallcoverings; materials provided by ID

- WG-Sisal Song / Ebony & Ivory GOH 31946632 52/54" wide
Reverse hang; random match; osnaburg backing; Class A ASTM E 84

Replace existing suspended ceiling tiles + t-grid with new

- Armstrong #1490 / Yuma White, 2' x 4' with Tegular Edge
Prelude 15/16-in suspension system

<https://www.armstrongceilings.com/commercial/en-us/commercial-ceilings-walls/canyon-ceiling-tiles/item/1490.html>

Electrical + Lighting

Retain existing troffer light fixtures; re-lamp with LED T8 Tube, 18watts, Frosted Lens, 2400 Lumens, 3500K-Neutral White, minimum 240 beam spread

• **Registry Department**

Finishes

Prep millwork, repair as needed, prime and paint

- Dunn Edwards DET619 Celluloid / Low Sheen Finish

Note: Paint door to electrical panel box

- Dunn Edwards DET619 Celluloid / Low Sheen Finish

Prep structural columns, repair as needed, prime and paint

- Dunn Edwards DET619 Celluloid / Low Sheen Finish

Install wallcoverings; materials provided by ID

- WG-Savannah / Silver Statue GOH 31946648
Reverse hang; random match; osnaburg backing; Class A ASTM E 84
- East Wall Only: Astoria / Cabling A197-561 52/54" Wide
Reverse hang; random match; osnaburg backing; Class A ASTM E 84

Replace existing suspended ceiling tiles + t-grid with new

- Armstrong #1490 / Yuma White, 2' x 4' with Tegular Edge
Prelude 15/16-in suspension system

<https://www.armstrongceilings.com/commercial/en-us/commercial-ceilings-walls/canyon-ceiling-tiles/item/1490.html>

Electrical + Lighting

Retain existing troffer light fixtures; re-lamp with LED T8 Tube, 18watts, Frosted Lens, 2400 Lumens, 3500K-Neutral White, minimum 240 beam spread

Install GFCI wall outlet on north wall, approx 30" in from east exterior wall @ 42" AFF; mount horizontal for future coffee bar

• **Finance / Accounting Department**

Finishes

Prep millwork, repair as needed, prime and paint

- Dunn Edwards DET619 Celluloid / Low Sheen Finish

Prep structural column, repair as needed, prime and paint

- Dunn Edwards DET619 Celluloid / Low Sheen Finish

Install wallcoverings; materials provided by ID

- WG-Savannah / Silver Statue GOH 31946648

Reverse hang; random match; osnaburg backing; Class A ASTM E 84

- East Wall Only: Astoria / Cabling A197-561 52/54" Wide

Reverse hang; random match; osnaburg backing; Class A ASTM E 84

Replace existing suspended ceiling tiles + t-grid with new

- Armstrong #1490 / Yuma White, 2' x 4' with Tegular Edge

Prelude 15/16-in suspension system @ 108" AFF

<https://www.armstrongceilings.com/commercial/en-us/commercial-ceilings-walls/canyon-ceiling-tiles/item/1490.html>

Electrical + Lighting

Retain existing troffer light fixtures; re-lamp with LED T8 Tube, 18watts, Frosted Lens, 2400 Lumens, 3500K-Neutral White, minimum 240 beam spread

• **Bohnet Office**

Finishes

Prep millwork, repair as needed, prime and paint

- Dunn Edwards DET619 Celluloid / Low Sheen Finish

Install wallcoverings; materials provided by ID

- WG-Sisal Song / Ebony & Ivory GOH 31946632

Reverse hang; random match; osnaburg backing; Class A ASTM E 84

- South Wall Only: WG-Denail DNL9020 Color: Storm

Reverse hang; random match; osnaburg backing; Class A ASTM E 84

Note: This wallcovering to be installed horizontal

Replace existing suspended ceiling tiles + t-grid with new

- Armstrong #8013 Ledges II / White, 2' x 2' with Flush Tegular Edge Superfine 9/16" suspension system @ 108" AFF

<https://www.armstrongceilings.com/pdbupimages-clg/219424.pdf/download/data-sheet-ledges.pdf>

Electrical + Lighting

Retain existing troffer light fixtures; re-lamp with LED T8 Tube, 18watts, Frosted Lens, 2400 Lumens, 3500K-Neutral White, minimum 240 beam spread

• **Controller, Payroll, Production Office**

Finishes

Prep millwork, repair as needed, prime and paint

- Dunn Edwards DET619 Celluloid / Low Sheen Finish

Install wallcoverings; materials provided by ID

- WG-Sisal Song / Ebony & Ivory GOH 31946632

Reverse hang; random match; osnaburg backing; Class A ASTM E 84

- South Wall Only: WG-Denail DNL9020 Color: Storm

Reverse hang; random match; osnaburg backing; Class A ASTM E 84

Note: This wallcovering to be installed horizontal

Replace existing suspended ceiling tiles + t-grid with new

- Armstrong #8013 Ledges II / White, 2' x 2' with Flush Tegular Edge Superfine 9/16" suspension system @ 108" AFF

<https://www.armstrongceilings.com/pdbupimages-clg/219424.pdf/download/data-sheet-ledges.pdf>

Electrical + Lighting

Retain existing troffer light fixtures; re-lamp with LED T8 Tube, 18watts, Frosted Lens, 2400 Lumens, 3500K-Neutral White, minimum 240 beam spread

• **New Adm. Assistant Office, New South VP Office**

Finishes

Prep millwork, repair as needed, prime and paint

- Dunn Edwards DET619 Celluloid / Low Sheen Finish

Install wallcoverings; materials provided by ID

- South Wall Only: WG-Denail DNL9020 Color: Storm

Reverse hang; random match; osnaburg backing; Class A ASTM E 84

Note: This wallcovering to be installed horizontal

Note: Shutters remain; line of demarcation for this wall covering ends approx 12" to the left of bank of shutters., where south VP Office systems Panel will be installed perpendicular to exterior wall (refer to plan and coordinate with ID)

Replace existing suspended ceiling tiles + t-grid with new

- Armstrong #8013 Ledges II / White, 2' x 2' with Flush Tegular Edge Superfine 9/16" suspension system @ 108" AFF

<https://www.armstrongceilings.com/pdbupimages-clg/219424.pdf/download/data-sheet-ledges.pdf>

Electrical + Lighting

Retain existing troffer light fixtures; re-lamp with LED T8 Tube, 18watts, Frosted Lens, 2400 Lumens, 3500K-Neutral White, minimum 240 beam spread

• **New Retreat B - Open Common Area**

Finishes

Prep millwork, repair as needed, prime and paint

- Dunn Edwards DET619 Celluloid / Low Sheen Finish

Install wallcoverings; materials provided by ID

- South Wall Only: WG-In A Flash / Y47832FL Charcoal Sheen 52" wide

Note: Shutters remain; line of demarcation for this wall covering ends approx 12" to the right of bank of shutters., where south VP Office systems Panel will be installed perpendicular to exterior wall (refer to plan and coordinate with ID)

- East Wall Only: Atmosphere #A-180-597 / Metallica (horizontal pattern)

Reverse hang; random match; osnaburg backing; Class A ASTM E 84

Note: This is the exterior west wall of Payroll office.

Replace existing suspended ceiling tiles + t-grid with new

- Armstrong #1490 / Yuma White, 2' x 4' with Tegular Edge Prelude 15/16-in suspension system @ 108" AFF

<https://www.armstrongceilings.com/commercial/en-us/commercial-ceilings-walls/canyon-ceiling-tiles/item/1490.html>

Electrical + Lighting

Retain existing troffer light fixtures; re-lamp with LED T8 Tube, 18watts, Frosted Lens, 2400 Lumens, 3500K-Neutral White, minimum 240 beam spread

• **Morgan Office**

Finishes

Prep millwork, repair as needed, prime and paint

- Dunn Edwards DET619 Celluloid / Low Sheen Finish

Install wallcoverings; materials provided by ID

- WG-Sisal Song / Ebony & Ivory GOH 31946632

Reverse hang; random match; osnaburg backing; Class A ASTM E 84

- South Wall Only: WG-Denail DNL9020 Color: Storm

Reverse hang; random match; osnaburg backing; Class A ASTM E 84

Note: This wallcovering to be installed horizontal

Replace existing suspended ceiling tiles + t-grid with new

- Armstrong #8013 Ledges II / White, 2' x 2' with Flush Tegular Edge
Superfine 9/16" suspension system @ 108" AFF

<https://www.armstrongceilings.com/pdbupimages-clg/219424.pdf/download/data-sheet-ledges.pdf>

Lighting + Electrical

Retain existing troffer light fixtures; re-lamp with LED T8 Tube, 18watts, Frosted Lens, 2400 Lumens, 3500K-Neutral White, minimum 240 beam spread

Install CAT 5/6 on east wall of office @ 5' in from south wall @ 12" AFF (existing CAT 5/6 is on west wall)

• **South Main Hall + West Employee Entrance**

Finishes

Prep millwork, repair as needed, prime and paint

- Dunn Edwards DET619 Celluloid / Low Sheen Finish

Install wallcoverings; materials provided by ID

- WG-In A Flash / Y47832FL Charcoal Sheen 52" wide

Reverse hang; random match; osnaburg backing; Class A ASTM E 84

Note: wallcovering installed just up to bump out on the right + adjacent to windows and doors

Replace existing suspended ceiling tiles + t-grid with new

- Armstrong #1490 / Yuma White, 2' x 4' with Tegular Edge
Prelude 15/16-in suspension system @ 108" AFF

<https://www.armstrongceilings.com/commercial/en-us/commercial-ceiling-walls/canyon-ceiling-tiles/item/1490.html>

Electrical + Lighting

Retain existing troffer light fixtures; re-lamp with LED T8 Tube, 18watts, Frosted Lens, 2400 Lumens, 3500K-Neutral White, minimum 240 beam spread

• **Hospital Management / West Wall only** (R Facing of Employee Entrance)

Finishes

Prep millwork, repair as needed, prime and paint

- Dunn Edwards DET619 Celluloid / Low Sheen Finish

Note: Paint door to electrical panel box

- Dunn Edwards DET619 Celluloid / Low Sheen Finish

Install wallcovering; materials provided by ID

- WG-In A Flash / Y47832FL Charcoal Sheen 52" wide

Reverse hang; random match; osnaburg backing; Class A ASTM E 84

Note: this wallcovering installed only on two bump outs on the far right and left (refer to plan for details)

Install wallcovering; materials to be provided by ID

- WG - Serra / Charcoal GOH 31946656 52" wide / 32oz vinyl
straight hang / random match; osnaburg backing; Class A ASTM E 84

Replace existing suspended ceiling tiles + t-grid with new

- Armstrong #1490 / Yuma White, 2' x 4' with Tegular Edge
Prelude 15/16-in suspension system @ 108" AFF

<https://www.armstrongceilings.com/commercial/en-us/commercial-ceilings-walls/canyon-ceiling-tiles/item/1490.html>

Electrical + Lighting

Retain existing troffer light fixtures; re-lamp with LED T8 Tube, 18watts, Frosted Lens, 2400 Lumens, 3500K-Neutral White, minimum 240 beam spread

Install GFCI wall outlet on north wall, approx 30" in from south hall @ 42" AFF; mount horizontal; for future coffee bar

• **Nurse Placement Department**

Finishes

Prep structural columns, repair as needed, prime and paint

- Dunn Edwards DET619 Celluloid / Low Sheen Finish

Replace existing suspended ceiling tiles + t-grid with new

- Armstrong #1490 / Yuma White, 2' x 4' with Tegular Edge

Prelude 15/16-in suspension system @ 108" AFF

<https://www.armstrongceilings.com/commercial/en-us/commercial-ceilings-walls/canyon-ceiling-tiles/item/1490.html>

Electrical + Lighting

Retain existing troffer light fixtures; re-lamp with LED T8 Tube, 18watts, Frosted Lens, 2400 Lumens, 3500K-Neutral White, minimum 240 beam spread.

Provide power and CAT 5/6 to Systems FFE in ceiling above space; Systems FFE provider will be specifying electrical requirements and plans for locations in their specification documents.

• IT Software Development

Finishes

Prep millwork, repair as needed, prime and paint

- Dunn Edwards DET619 Celluloid / Low Sheen Finish

Install wallcovering; materials provided by ID

Note: Wallcovering on exterior side of south wall only adjacent to Server Room

Replace existing suspended ceiling tiles + t-grid with new

- Armstrong #8013 Ledges II / White, 2' x 2' with Flush Tegular Edge
Superfine 9/16" suspension system @ 108" AFF

<https://www.armstrongceilings.com/pdbupimages-clg/219424.pdf/download/data-sheet-ledges.pdf>

Electrical + Lighting

Retain existing troffer light fixtures; re-lamp with LED T8 Tube, 18watts, Frosted Lens, 2400 Lumens, 3500K-Neutral White, minimum 240 beam spread

• Classroom

Finishes

Prep millwork, repair as needed, prime and paint

- Dunn Edwards DET619 Celluloid / Low Sheen Finish

Install wallcovering; materials provided by ID

- WG-In A Flash / Posh Pebble GOH 31946622 / 54" 20oz vinyl
Reverse hang; random match; osnaburg backing; Class A ASTM E 84

Replace existing suspended ceiling tiles + t-grid with new

- Armstrong #1490 / Yuma White, 2' x 4' with Tegular Edge
Prelude 15/16-in suspension system @ 108" AFF

<https://www.armstrongceilings.com/commercial/en-us/commercial-ceilings-walls/canyon-ceiling-tiles/item/1490.html>

Electrical + Lighting

Replace light fixtures with 2' x 4' LED Back-Lit Flat Panel, 20 watt, 2400 Lumens, 3500K-Neutral White

• North Entry

Finishes

Prep millwork, repair as needed, prime and paint

- Dunn Edwards DET619 Celluloid / Low Sheen Finish

Install wallcovering; materials provided by ID

- Haggerston #8-3365 / Dandelion (multi-tone neutral)

Reverse hang; random match; osnaburg backing; Class A ASTM E 84

Replace existing suspended ceiling tiles + t-grid with new

- Armstrong #1490 / Yuma White, 2' x 4' with Tegular Edge
Prelude 15/16-in suspension system @ 108" AFF

<https://www.armstrongceilings.com/commercial/en-us/commercial-ceilings-walls/canyon-ceiling-tiles/item/1490.html>

Electrical + Lighting

Replace light fixtures with 2' x 4' LED Back-Lit Flat Panel, 20 watt, 2400 Lumens, 3500K-Neutral White

• EVP / COS Office

Remove desk and adjacent files on west wall of office

Repair walls, floor as needed; repair base + repaint

Finishes

Prep millwork, repair as needed, prime and paint

- Dunn Edwards DET619 Celluloid / Low Sheen Finish

Install wallcovering; materials provided by ID

- 54" wide sheet vinyl (TBD)

EXTERIOR

Exterior Painting

Main body of the building:

- Dunn Edwards DEW 379 Igloo

Vertical Bump Outs at each set of windows

- Dunn Edwards DEC 792 Cape Cod Blue

Stucco Band along base of building

- Dunn Edwards DE 6206 Desert Suede

CMU wall on northwest corner

- Dunn Edwards DE 6206 Desert Suede

Decorative concrete block in wall openings in CMU half-walls surrounding mechanical + dumpster location

- Dunn Edwards DEC 792 Cape Cod Blue

Note: Samples to be applied to south wall for ID approval

Exterior metal doors on north end and at garage doors

- Dunn Edwards DE 6206 Desert Suede

Note: Do not paint garage doors as these will be replaced at later date

Install stacked stone under each set of windows on East, South + West side from grade to bottom of window frames; install horizontal stacked stone under fixed glass windows @ employee entrance

- Golden White 6" by 24" Ledger Stone / 7.75 sq foot per piece

Source: Pacific Stone Supply / Brandon Schaeffer \ Voice: 760-895-3678

Email: pacificstoneinfo@gmail.com

• Additional Notes :

Client requests additional sound / noise mitigation in certain offices; recommend layering new sound-block gypsum board over existing walls; Client to identify locations of problem areas;

Suggested Product: <https://www.quietrock.com/products/quietrock-530rf>

With certain Systems walls going to the ceiling, need to address locations of lighting, HVAC and fire sprinklers specifically in these areas:

- New East Adm. Assistant Office (outside of existing East VP Office)
- New HR Department
- New South Adm. Assistant Office
- New South VP Office

Client runs operations 24/7 + 365 so work to be scheduled in such a manner as to avoid excessive interruptions including certain aspects of the project scheduled on a Saturday, Sunday, Evenings, etc.

Contractor to coordinate efforts and installations with other team and vendor partners to provide for smooth order of work and avoid crossovers + conflicts.

Contractor to verify all dimensions prior to any work.
Contractor to provide yardage requirements for wallcoverings.

Work spaces are to be broom swept, debris removed and staging kept organized regularly during project implementation.

Contractor responsible for any additional drawings, engineering calculations, specifications and/or permits, if required or as needed.

At significant conclusion of projects, thoroughly clean interior, including wash windows and doors, clean HVAC filters, wet mop LVT floor, wet clean bathrooms.

Change orders are to be in writing and approved by all parties before proceeding and are to include start and end date, estimated delay in schedule and projected or additional costs, if any.

Contractor is welcome to value engineer work that can positively impact time schedule or reduce costs of procurement and advise client and interior designer.

Project Addendum #1

As Of: November 10, 2020

- Employee Breakroom (formerly garage bays)

Remove all existing base and wall cabinetry on two south walls and properly dispose; repair and repaint drywall on south walls as needed.

Replace cabinetry with new base and wall cabinets as per plan; install new laminate counter; install new single compartment sink, touches faucet and soap dispenser; install new refrigerator, oven and microwave appliances; install recycle pull-outs.

Note: Painting of entire interior of space to be completed during removal of garage doors and installation of 6 sets of French doors, a part of the the exterior phase.

Client to advise what existing appliances will be re-used.

KD Cabinets + hardware to be provided by ID; install by GC

Counters plus installation of sink, faucet, oven-microwave stack by GC

See Plan and Elevation For Cabinetry.

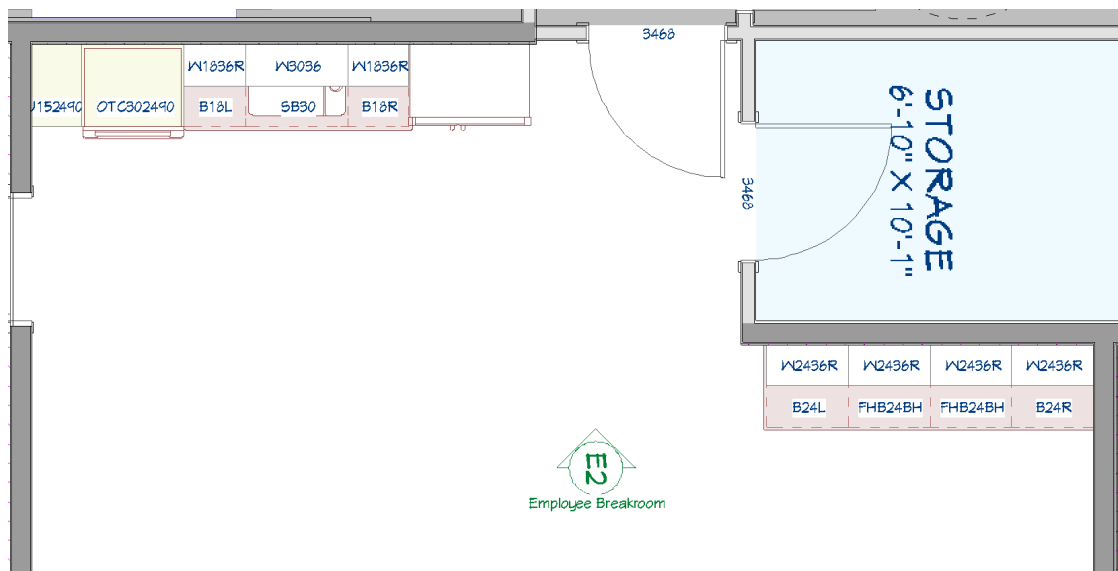

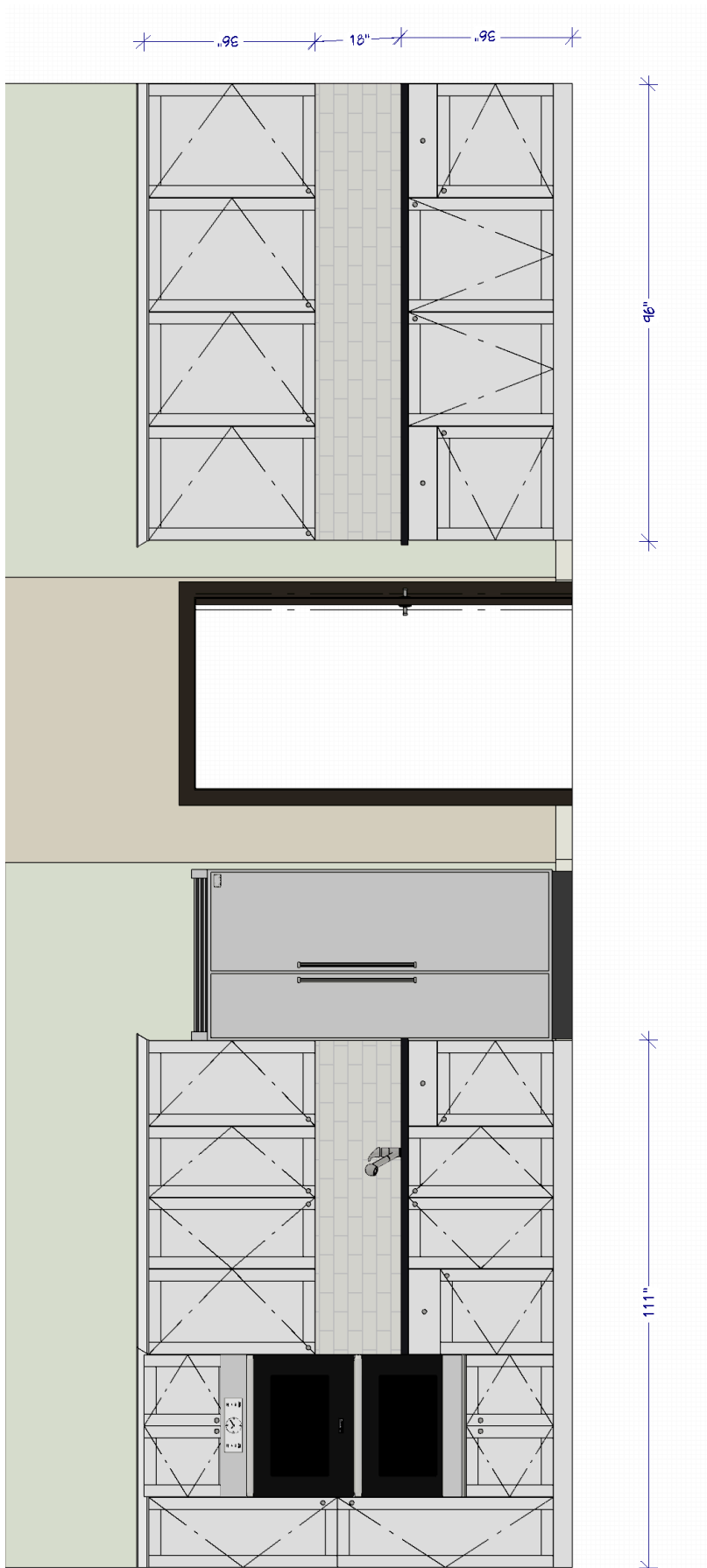

Project Addendum #2

As Of: November 22, 2020

- Executive VP / COS Office

Remove the existing granite tops, desk, return, back return and section of base file cabinets from the west wall.

Make repairs to west and south walls, flooring and millwork as needed.

Remove existing wallcovering and replace with new 54" sheet vinyl